

Installation instruction

AQT3-36/630KT

Apply to 18/30kV XLPE Insulated Power Cable.Suitable for cable cross section 35-400mm²

AHT3-36/630KT

Inner diameter of Cable adaptor	∅16	∅20	∅25	∅30	∅35	∅40
Type of adaptor body	20-24	24-28	28-33	33-38	39-43	44-50
Cable section(mm ²)		35/50/70	95/120/150	185/240	300/400	500

Components Description

- | | | |
|-------------------------|--------------------|------------------------------|
| 1 Bushing | 8 Copper screen | 15 Nut |
| 2 Cable core | 9 Bolt | 16 Insulating plug |
| 3 Lug | 10 Front connector | 17 Screen cover |
| 4 Core insulation | 11 Cable adaptor | 18 Linking rod |
| 5 Semi-conductive layer | 12 Earthing wire | 19 Rear connector |
| 6 Position device | 13 Flat washer | 20 Rear connector w/arrester |
| 7 Insulation tube | 14 Spring washer | 21 Tinned soft wire |

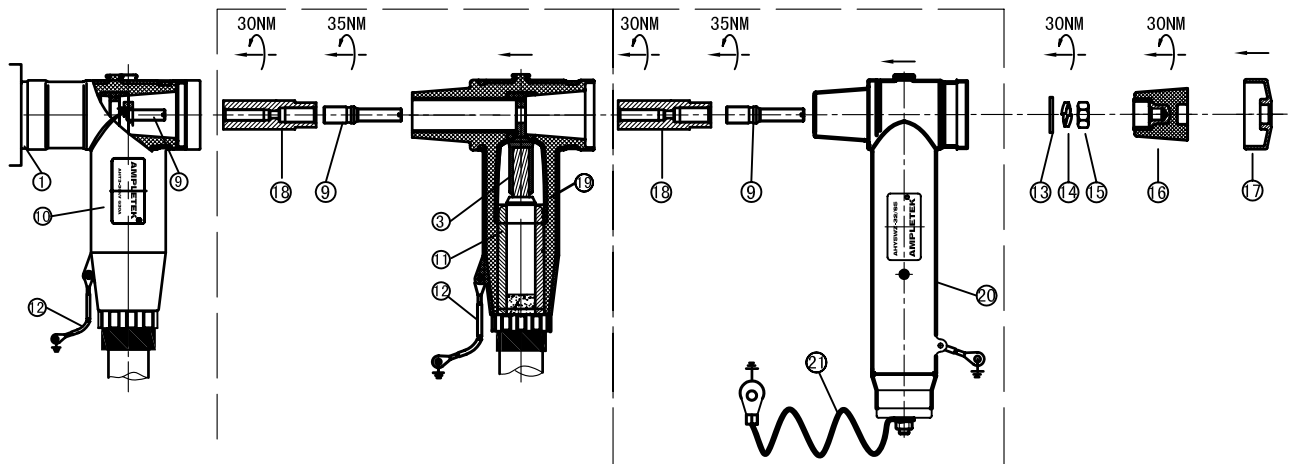
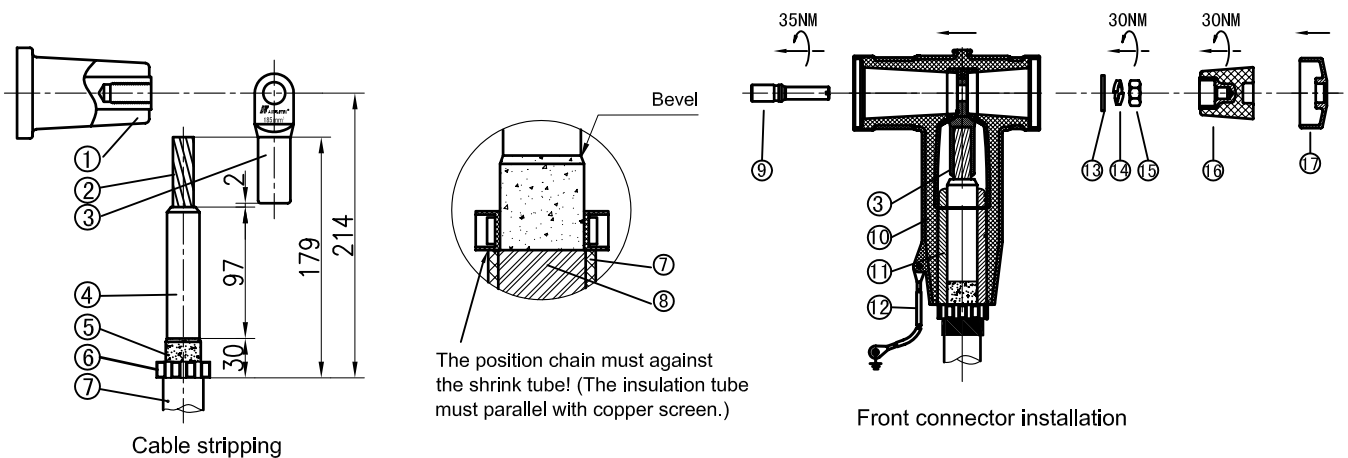

Attention: This products need to be installed by trained electrical engineer following the safe using guide of high-voltage equipment.

- The length of phase shall not less than 650mm.
- Do not cut core insulation, Make a bevel at semi-conductive layer and core insulation.
- Cut the cold (heat) shrink tube circularly, make sure the trim cutting and accurate size.
- The position chain is fixed on the semi-conductive layer against up port of shrink tube.
- The direction of lug hole and bushing should be in the same line when compress the lug.
- Must keep the contact parts clean before daub the lubricate evenly.