

## ► Lateral bus-bar system-----Type I



Type: AMLD-15  
15kV I plug



Type: AML-15  
15kV I Bus-bar connector



15kV I Bus-bar socket

1. I type plug/ bus-bar connector is suitable for the consolidation connection of ring main unit.
2. Supply more branches for expansion.
3. A prior option to combined ring main units.
4. I type bus-bar socket is applying to 10kV electrical system, when the lateral side of the ring main unit to be extension, when the lateral side of the ring main unit to be extension and be more branches combined cabinets, it is used for the port of the bus-bar , it is designed tightly and easy for installation.
5. I type is suitable for Ormazabal, Tianning, Huostone, Zhengchao etc brand.

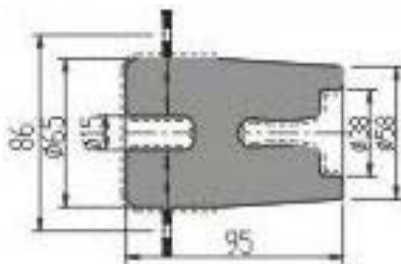

15kV I plug

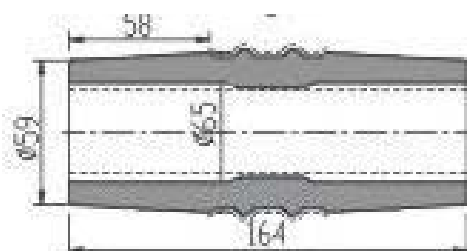

15kV I Bus-bar connector

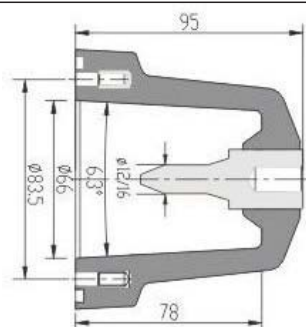

15kV I Bus-bar socket