

# AMPLETEK Cable accessories - Medium Voltage

## ▶ 35kV Top-end

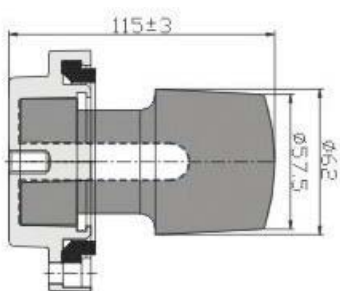

Type: AMT-DYH1.1  
DYH1#-1 Top-end



1. 35kV Top-end provide insulating protection for 35kV ring main unit.
2. The spare outgoing line should be sealed by 35kV top-end.
3. 1#,2#,3# inner cone top-end is respectively suitable for 35kV 1# , 2#, 3# Inner cone socket. 1#-1,1#-2 top-end is suitable for 35kV transformer.



Type: AMT-35-1  
35kV 1# Top-end

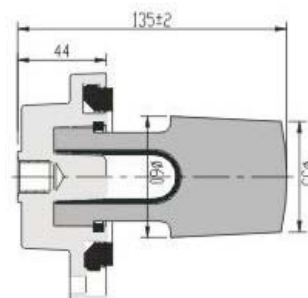

1#



Type: AMT-DYH1.2  
DYH1#-2 Top-end

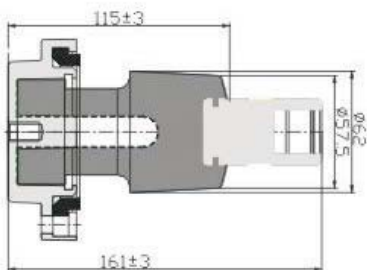

Type: AMT-35-2  
35kV 2# Top-end

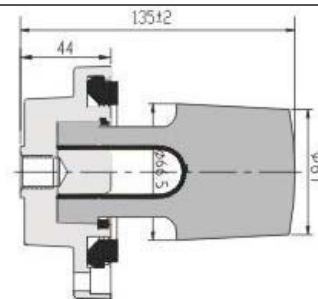

2#



Type: AMT-35-3  
35kV 3# Top-end

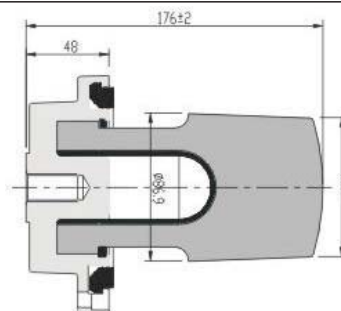

3#